

OVERWEIGHT AND OVERSIZE TRUCK PERMITTING ON LOCAL ROADWAYS



- Joelle VanderLinden
 - Brent Bogar

ND County Roads Conference – NDACE

January 26 – 28, 2022



LoadPass

PERMITS





LoadPass Permits

A uniform system for the permitting of overweight and oversized loads on participating county, township, and city roadways.

Why LoadPass Permits?

- Provides uniformity across local government lines for both local governments and industry
- Single point for industry to obtain permits for multiple local governments
- Manage traffic using color-coded LoadPass user-friendly Dashboard



LoadPass Permits – Membership Benefits

- Retain control of local roads
- Increase revenues for road maintenance
- Reduce office and telephone traffic
- Receive funds via ACH into account each month
- Prepare for future projects
 - Pipelines
 - Wind Farms
 - Energy Industry
 - Construction
 - Agriculture





LoadPass Permit Counties & Cities

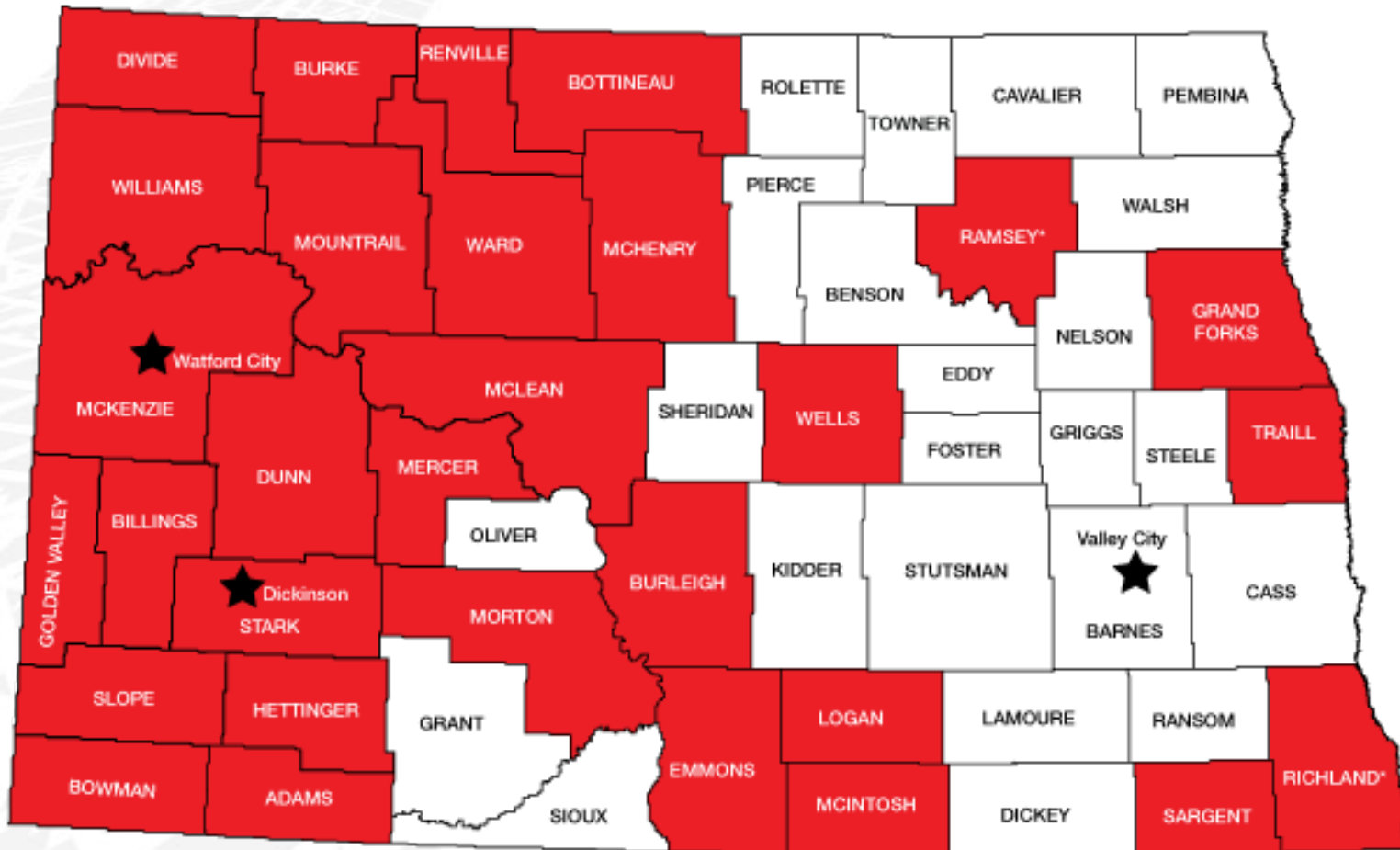

*Effective 1/1/2021



Total Number of Permits Sold on behalf of all Members Annually 2009-2021

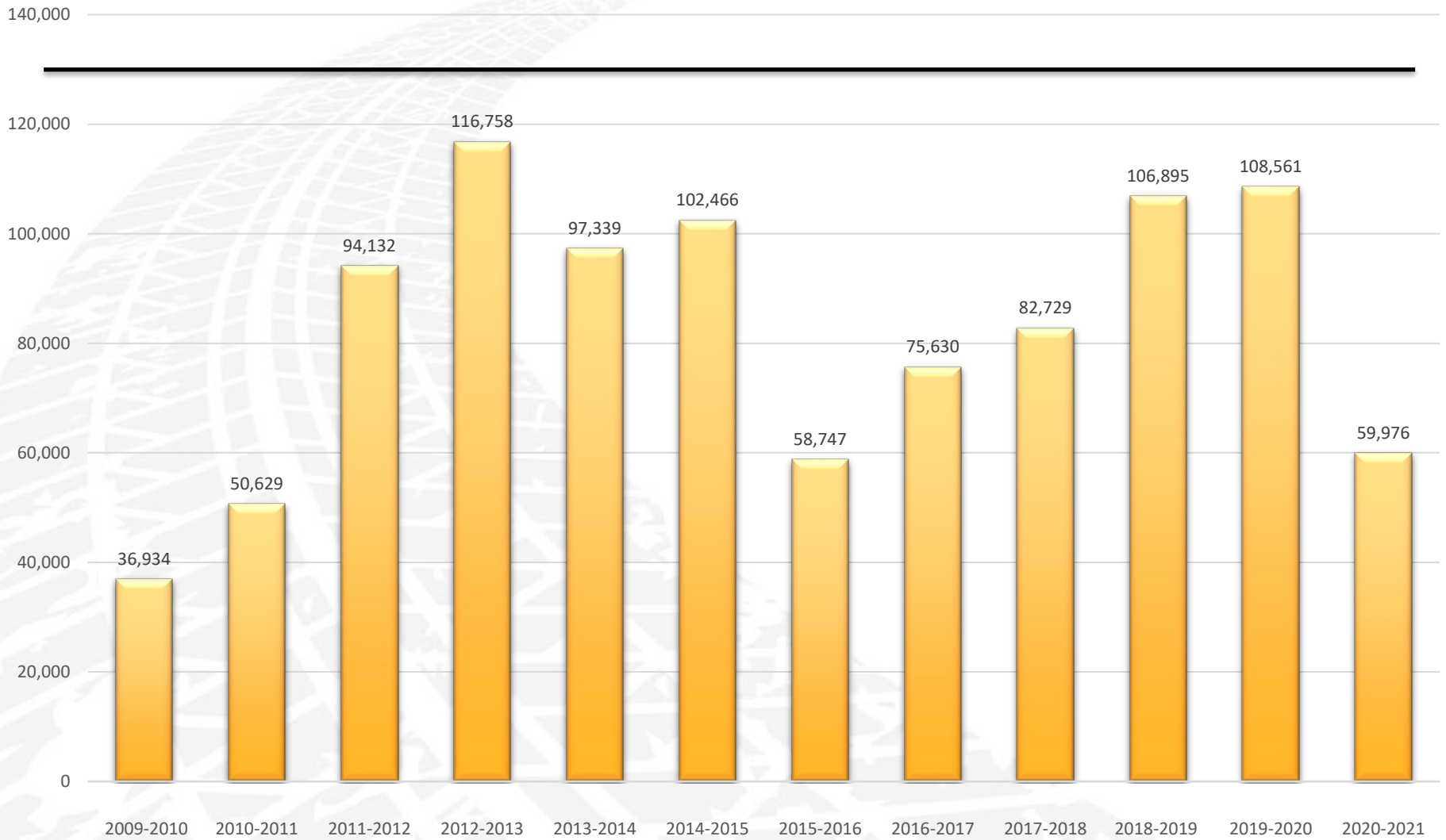

LoadPass Routable Map

LoadPass Routing Application

Weight

pounds

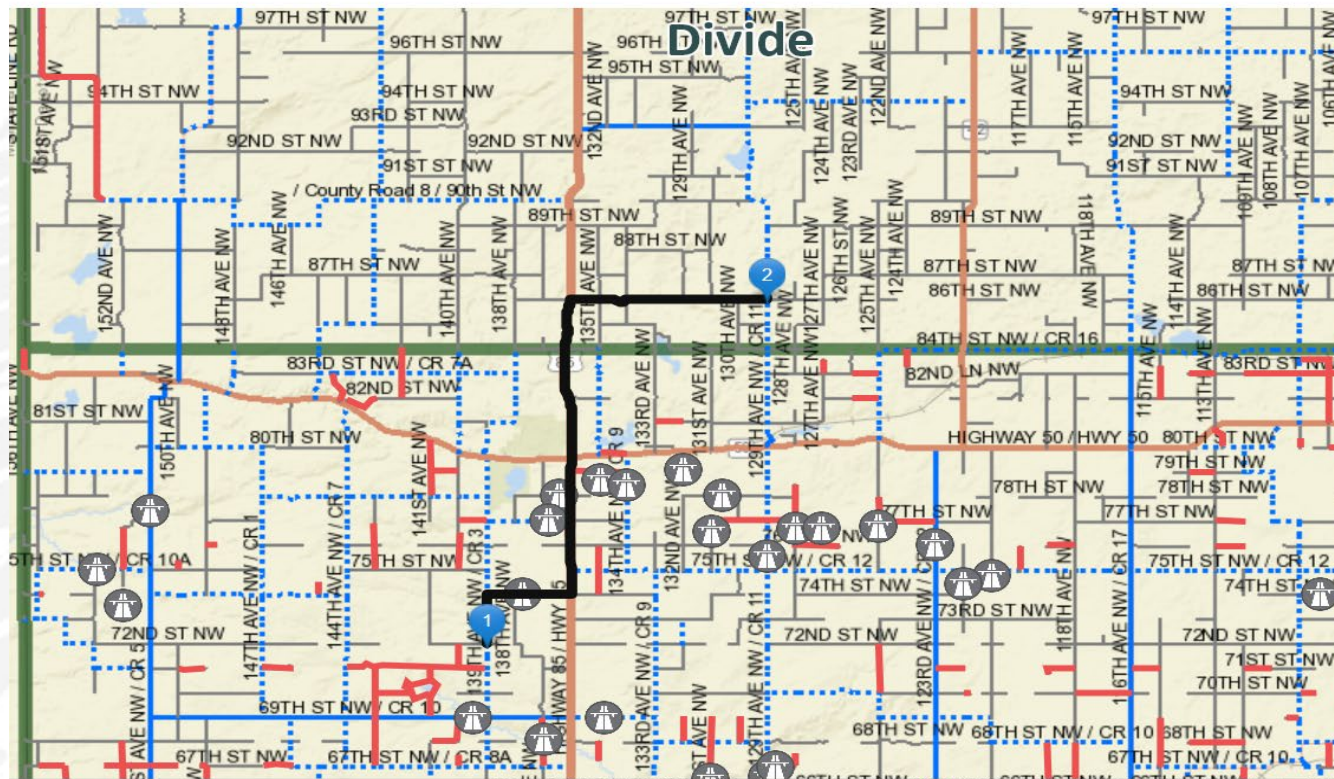

Directions

24.18 miles

1. Start at 72nd St, Williston, North Dakota, 58801_1004
2. Go northeast on 72ND ST NW toward 139TH AVE NW
0.07 mi
3. Turn left on 139TH AVE NW
1.93 mi · 3 min
4. Turn right on 74TH ST NW
2.99 mi · 4 min
5. Turn left on



WISE Roads

*Weather Information System to Effectively
Reduce Oilfield Delays and Disruptions*

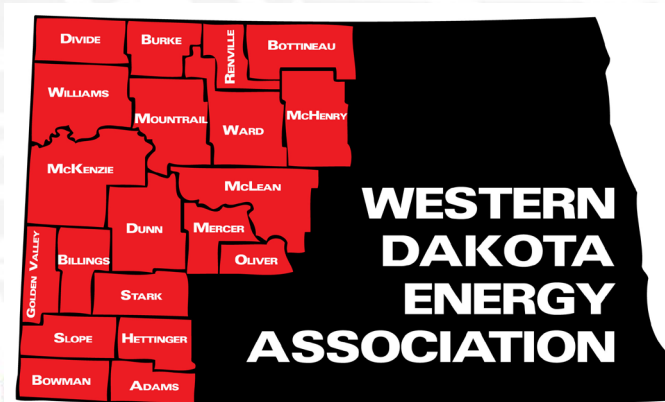

Wise Roads Project

- ✓ Work with research partners, agriculture, and Industry to maximize benefit
- ✓ Install research-grade weather stations in areas with heavy oilfield traffic
- ✓ Make data publicly available through NDAWN, LoadPass and other sites
- ✓ Provide training to road managers through LTAP



NDSU

UPPER GREAT PLAINS
TRANSPORTATION INSTITUTE
NORTH DAKOTA LOCAL TECHNICAL ASSISTANCE PROGRAM



Spring 2019 NDAWN Stations

- 8 total weather stations in “Big Four” Counties
- McKenzie and Dunn County each only had 1 station
- >40 miles between some stations

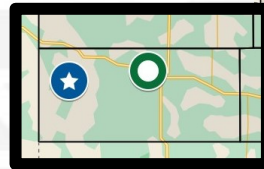
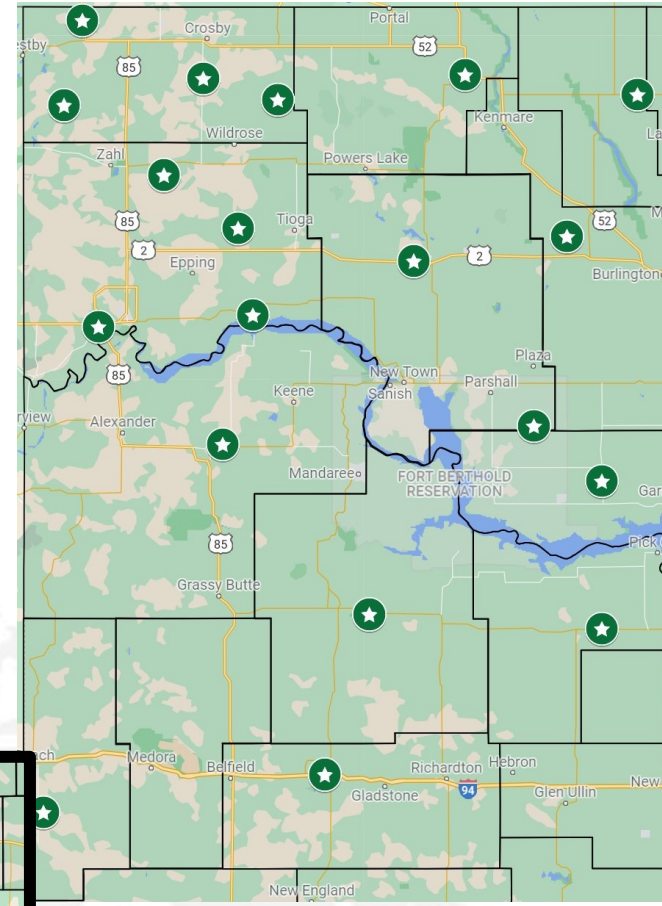

Current NDAWN Stations

- 35 additional full-instrumentation weather stations installed since June 2019
- 7 additional rain gauge only sites
- “Big Four” counties have a total of 42 stations
- ~12 mile spacing

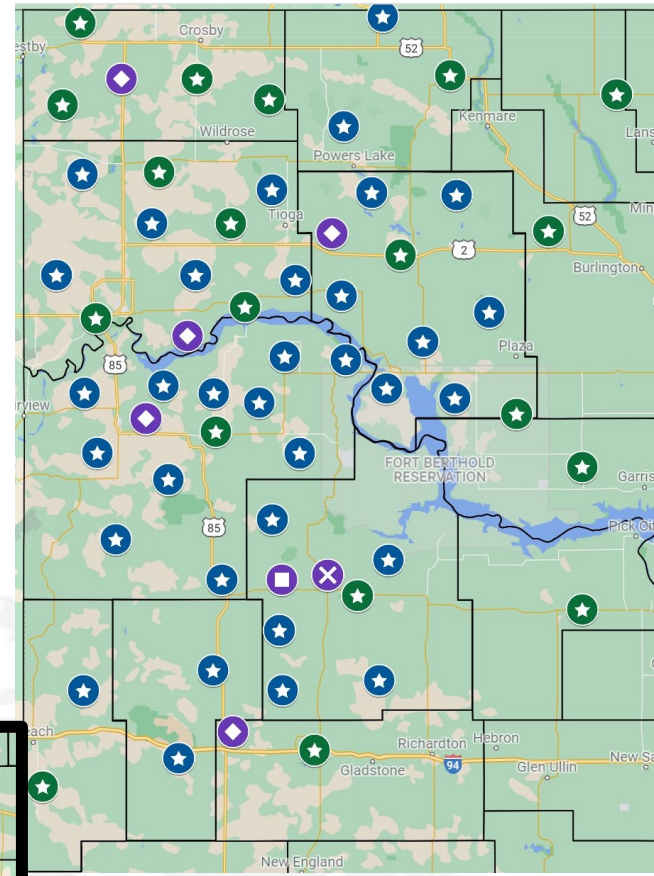

Road Temperature & Moisture Probes

- Installed at three locations
- Probes installed at 4 depths: 6-8", 24", 48", 72" from surface
- Temperature and volumetric water content (VWC) measured at each depth
- Used for monitoring frost depth and moisture infiltration



Live Video Streaming

- Available on PC/Mac and mobile devices
- Live video with Pan/Tilt/Zoom capability

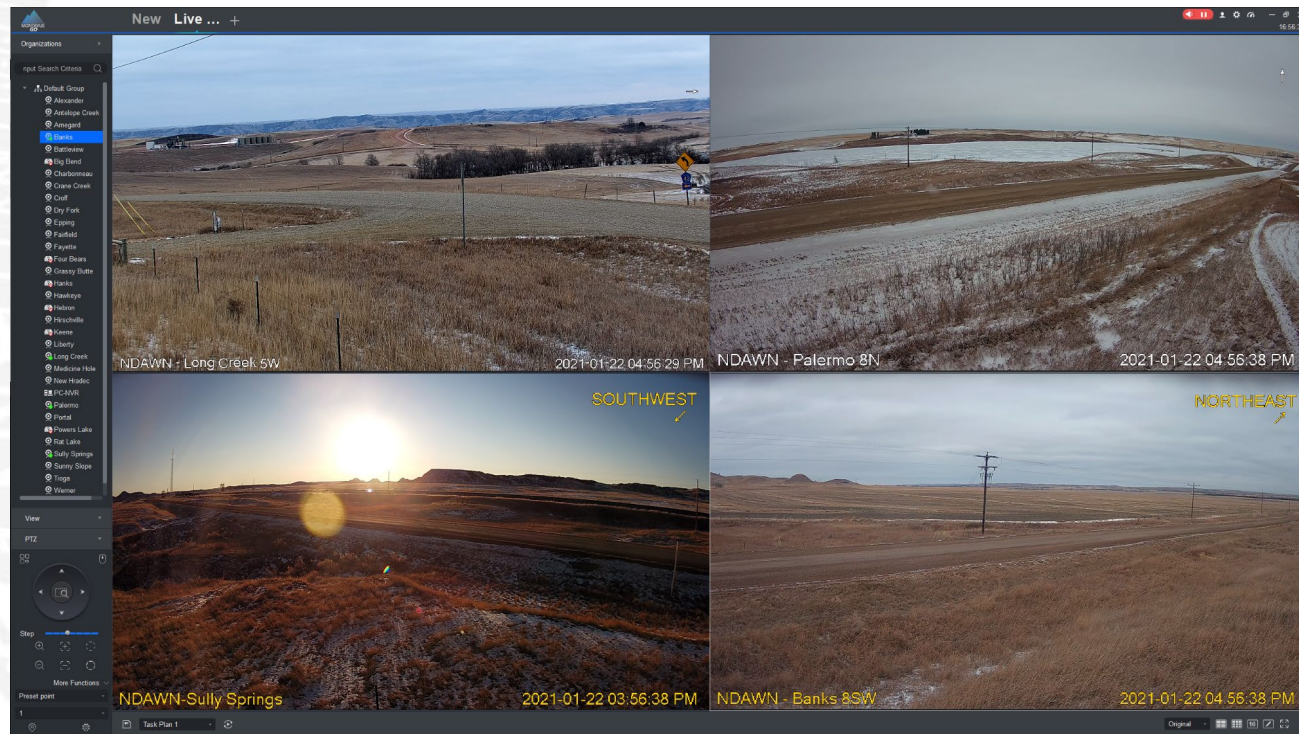

LoadPass

PERMITS



NOTIFICATIONS





LoadPass Communication System

- In 2012, the LoadPass Communication System was implemented.
 - Counties/Cities/Townships can post load restrictions, road closings, restrictions lifted, construction projects, etc., and the notification will be emailed or texted to all who have registered to receive the notifications.
 - We currently have over 2,000 users registered to receive text notifications and over 6,000 registered to receive email notifications.
 - In 2021, the system sent out almost 6 million emails and 1.5 million text messages to users

Signing up for Notifications



 [Restricted Road Map](#)

 [View Restrictions/Notifications](#)

 [Order Permits](#)

 [County Contacts](#)

 [Participating Communities](#)

A UNIFORM SYSTEM FOR THE PERMITTING OF OVERWEIGHT & OVERSIZED LOADS ON PARTICIPATING COMMUNITY ROADWAYS

OVERWEIGHT / OVERSIZED TRUCK PERMITS

We are the connection between local governments and the large load hauling industry for road information and requirements. Users can conveniently purchase e-permits directly online quickly and easily.

RESTRICTED COUNTY ROADS

Member communities often find the need to restrict the allowed weight on their roads due to the ever-changing North Dakota weather and road conditions. The LoadPass website provides a restricted road map for users to refer to for restricted road information, as well as updates.



701.566.5576
Permits@LoadPassPermits.com

PERMITS

[LoadPass Permits](#)

[Sign Up for LoadPass Permits](#)

ROADS

[View Restricted Roads Map](#)

[View Active Roads Restrictions](#)

[Sign Up for Notifications](#)

Recent News

Supreme Court Ruling

[¶5] LoadPass is an internet-accessible resource for participating counties, including Divide County, to provide notice of road restrictions. It allows users to obtain electronic overweight or oversize load permits and view road restrictions. Restrictions may be viewed as a list of notifications or through an interactive map. The district court found the inclement-weather weight restrictions were viewable in the notification list. However, the court found the interactive map on LoadPass showed the township roads were not restricted. Specifically, the court found that individual township roads on the map were not marked in red to indicate the weight restriction. Jason Pahl, the owner of Stateline Services, testified that when the company's dispatcher selected the township road where its driver was stopped, the informational display that appeared showed the road was not restricted. Further, the record shows the map has an "Alerts" feature allowing the user to search for restrictions on a particular type of road in the county, limiting the search, for example, to only county roads or only township roads. The court found there was an alert for restrictions on county roads, but no restrictions on township roads. The court found the trucks were traveling on township roads when they were pulled over, not county roads.



Updates

Axle Weight Update

Permitted Unit

Unit Description 

Enter unit number/descriptor for each piece of equipment in this permitted unit.

Power Unit

Fill out all applicable fields. Enter 'N/A' or '0' for non-applicable fields.







VIN 	<input type="text"/>	State Registered 	<input type="text"/>
Power Unit # 	<input type="text"/>	License Number 	<input type="text"/>
Year 	<input type="text"/>	License Weight 	<input type="text"/> lbs
Make 	<input type="text"/>		

Figure 1: Power unit information is now required for trip permits. The power unit describes the unit which supplies the power to the permitted unit (i.e., the tractor in a tractor/trailer combo).

Axle Weight Update

Add Axle to List

Axle Weight	<input type="text" value="Weight"/>	Axle Center to Next Axle Center
Number of Tires	<input type="text" value="# Tires"/>	Enter the length from this axle to the next axle on unit. Leave blank if this is the last axle on the unit.
Tire Width	<input type="text" value="Tire Width"/> <input checked="" type="radio"/> in <input type="radio"/> mm	<input type="text" value="Feet"/> ft. <input type="text" value="Inches"/> in.
Track Width	<input type="text" value="Feet"/> ft. <input type="text" value="Inches"/> in. (Outside wheel to outside wheel)	

Axle Weight Update

Axle Information							
	Axle #	Weight	Number of Tires	Tire Width	Track Width	Axle Center to Next Axle Center	
↑ ↓ ✎	1	10,000 lbs	4	11 in	8 ft. 6 in.	8 ft. 1 in.	🗑️
-- Axle Group Break --							
↑ ↓ ✎	2	12,000 lbs	4	11 in	8 ft. 6 in.	4 ft. 6 in.	🗑️
↑ ↓ ✎	3	12,000 lbs	4	11 in	8 ft. 6 in.	12 ft. 6 in.	🗑️
-- Axle Group Break --							
↑ ↓ ✎	4	12,000 lbs	4	11 in	8 ft. 6 in.	4 ft. 6 in.	🗑️
↑ ↓ ✎	5	12,000 lbs	4	11 in	8 ft. 6 in.	4 ft. 6 in.	🗑️
↑ ↓ ✎	6	12,000 lbs	4	11 in	8 ft. 6 in.		🗑️
Gross Weight: 70,000 lbs							

Figure 3: The axle table in the newest update. Axle group breaks are determined implicitly by the system where the spacing is 8 or greater. Axle information can be edited by clicking the blue pencil icon on the left side of the row to open the inline editor. Axles can be deleted by clicking the trashcan icon.

The summary section displays the permitted unit GVW and axle group information. It also contains a graphical display of the permitted unit to use for your reference. The graphical display will be different depending on what load type is selected: Trucks and Trailers; Workover Rigs, Cranes, & Special Mobile; or Roaded Earth Moving Equipment. The diagram is intended to aid in formatting your axles but may not perfectly reflect the appearance of your unit.

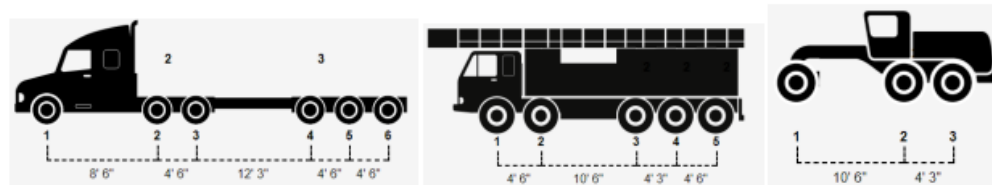

Figure 4: Depending on which load type is selected, the look of the diagram will differ. From left to right are example diagrams for the following load types: Truck & Trailer; Workover Rig, Crane & Special Mobile; Roaded Earth Moving Equipment.

Enhancements being Developed

- Law Enforcement Enhancement
 - Quick lookup for permit verification and reporting
- Administration Enhancement
 - Improved GIS functionality while using hand-held devices
- End User Enhancement
 - Improved GIS functionality while using hand-held devices

Contact Information

- Joelle VanderLinden– LoadPass Operator
701-426-6781
joelle@loadpasspermits.com
- Brent Bogar – LoadPass Consultant
701-770-3048
Brent.Bogar@AE2S.com
- Website - www.loadpasspermits.com
- Email – permits@loadpasspermits.com

