

DESIGN DATA			
Traffic	Average Daily		
Current 2022	Pass: 160	Trucks: 30	Total: 190
Forecast 2042	Pass: 210	Trucks: 45	Total: 255
Clear Zone Distance: 18'	Design Speed: 40 MPH		
Minimum Sight Dist. for Stopping: 333'	Bridges: HL-93 Design Loading		
Sight Dist. for No Passing Zone: N/A			
Pavement Design Life 20 (years)			
Design Accumulated One-way Flexible ESALs: 130,411			

STATE	PROJECT NO.	PCN	SECTION NO.	SHEET NO.
ND	IM-2-094(186)217	23344	1	1

NORTH DAKOTA DEPARTMENT OF TRANSPORTATION

IM-2-094(186)217

Kidder County
I-94/Pettibone Interchange

Grading, Aggregate Base, HMA Pavement, Structure Removal and Replacement,
Signing, Pavement Marking, and Guardrail

GOVERNING SPECIFICATIONS	Date Published and Adopted by the North Dakota Department of Transportation
Standard Specifications	7/1/2025
Supplemental Specifications	NONE

PROJECT NUMBER \ DESCRIPTION	NET MILES	GROSS MILES
IM-2-094(186)217	0.379	0.379

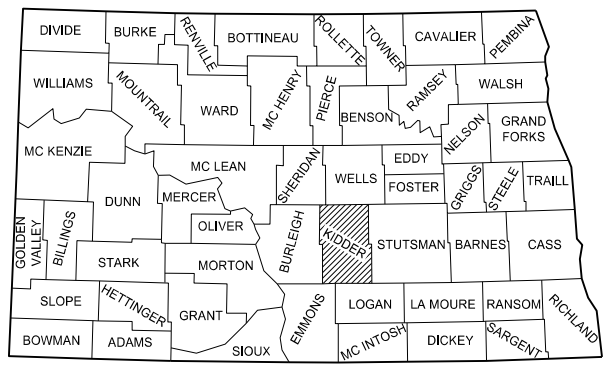
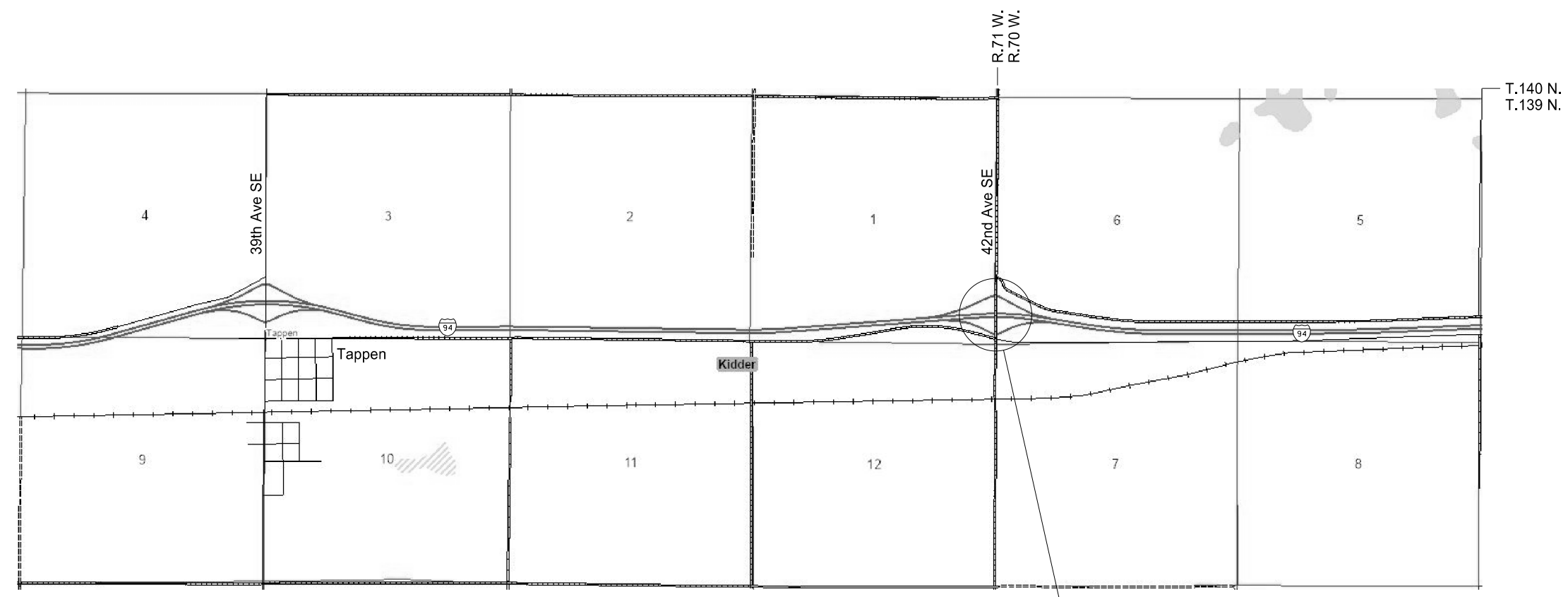
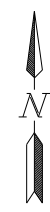

STATE COUNTY MAP

ND DEPARTMENT OF TRANSPORTATION
OFFICE OF PROJECT DEVELOPMENT

BRIDGE DIVISION

This document
is preliminary
and not for
construction or
implementation
purposes.

PRELIMINARY