

Typical Assembled Gabion Basket

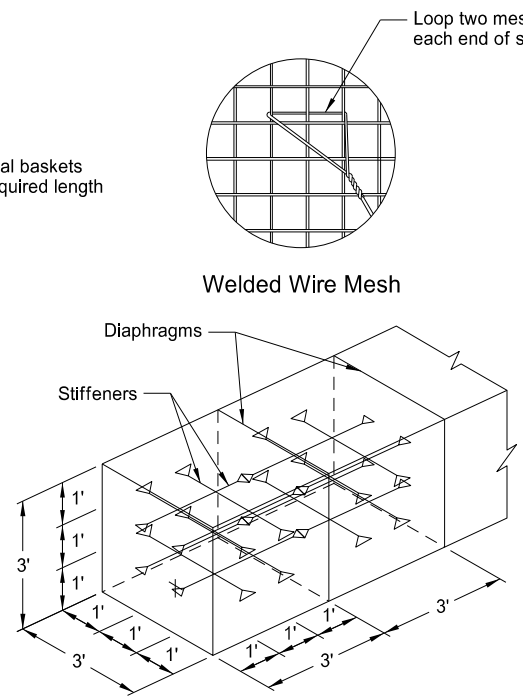

End Gabion Cells

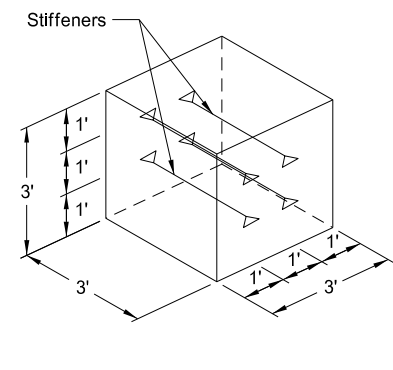

Interior Gabion Cells

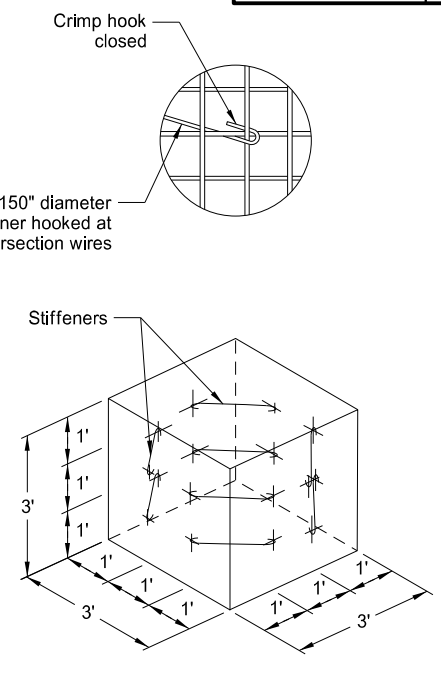

All Gabion Cells
Optional Gabion Stiffeners
(welded wire baskets)

Length (ft)	Height (ft)	Diaphragm Partitions	Capacity (CY)
6	3	1	2.00
9	3	2	3.00
12	3	3	4.00
6	1.5	1	1.00
9	1.5	2	1.50
12	1.5	3	2.00
6	1	1	0.67
9	1	2	1.00
12	1	3	1.33

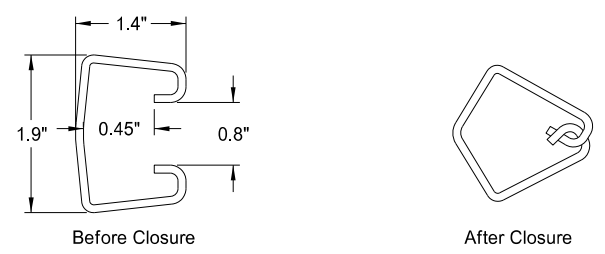

Interlocking Wire Fastener

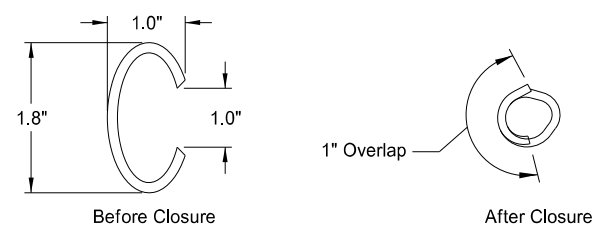

Overlapping Ring Wire Fastener

Alternate Tying Fasteners

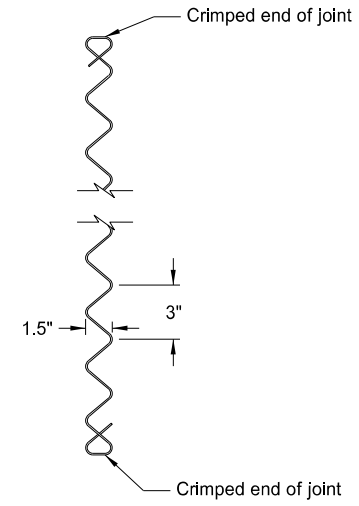

0.150" Diameter Spiral Fastener

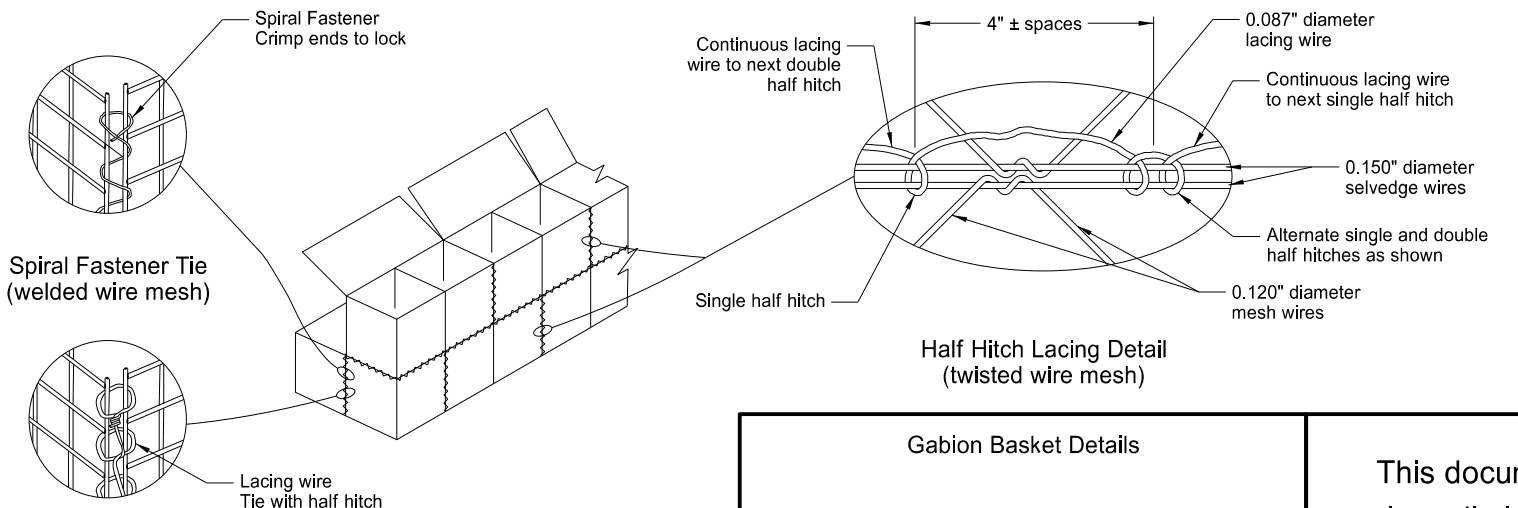

Typical Gabion Basket Installation

Gabion Basket Details
Project Description
Project Location

This document is preliminary and not for construction or implementation purposes.